

uebler

B I K E R A C K S

2023/24



Quality from Germany



Uebler stands for tradition and innovation "Made in Germany". The owner-managed company from the Franconian town of Forchheim develops and produces creative, yet practical solutions for bicycle transport - entirely in Germany with close ties to the region.

With qualified employees, value creation from development to production and assembly to sales takes place exclusively at the headquarters - in collaboration with reliable suppliers and partners from the region. This way, Uebler ensures that customers and trade partners receive technically outstanding products of the highest quality that rightly bear the quality seal "Made in Germany".

Multiple test winner

Uebler not only impresses its customers - the company has also prevailed in most product tests. A total of 49 test victories since 2011 is an outstanding figure!

The decisive factors for these very good ratings are the standards Uebler sets when it comes to ease of use, technically up-to-date solutions, quality standards and, above all, safety - always geared to the needs of the customers.

test wins summary 2019-2021



test wins summary 2021-2022



Conviction across the board

Spacers for 1st and 2nd bicycle, lockable and removable

Ratchet system for optimum fixing of bike wheels of almost any type and size

Widened bike rails suitable for all popular tyre widths

Integrated handle for easy folding out/in of the bike rails and lights (not available for all models)

Pedal for comfortable folding of the carrier (not available for all models)

Quick-release lock for all standard towbars

Preset quick-release levers for easy and secure adjustment of the rack U-bar

Design lights with high radiant power

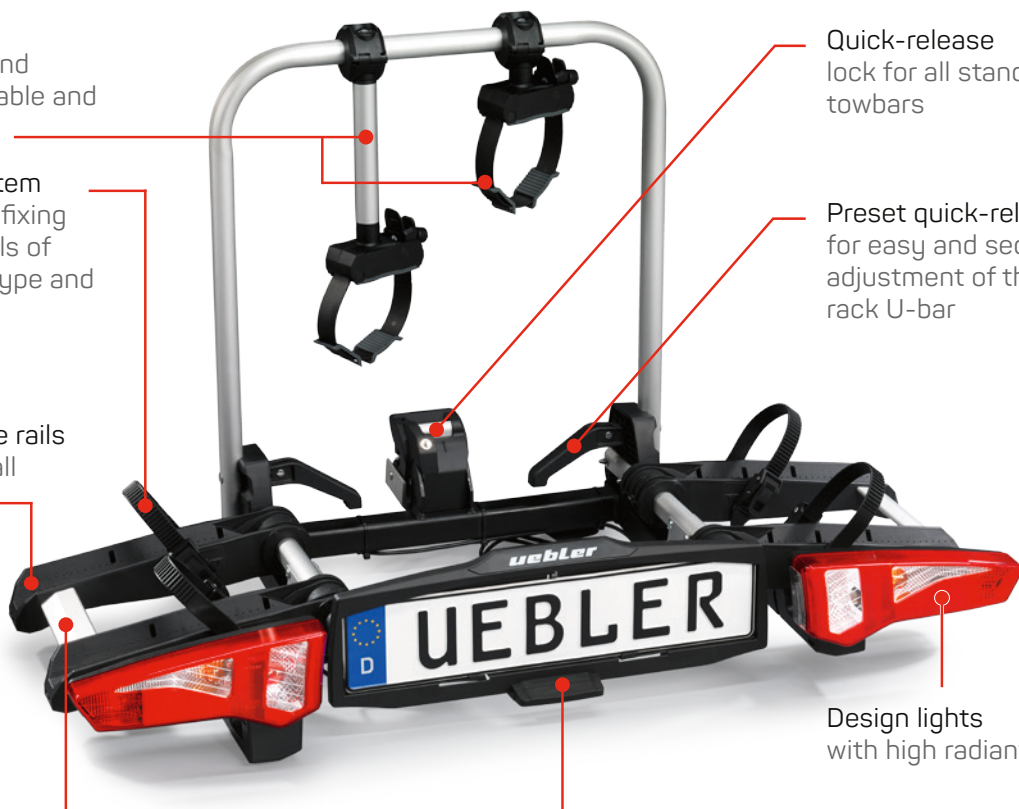

S-line

Spacer with clamps:



- 1 The spacer with clamps grips around standard frames. The spacers are easily mounted by pressing together the clamps with one hand.



- 2 Spacers with suitable length are available for every bicycle position.



- 3 The bicycles are fixed on the rack frames by the spacers.

Z-line

Spacer with toothed belt:



- 1 The spacer with toothed belt was developed for sheathing box-section frames. Press the red button, the spacer can then be mounted easily with only one hand.



- 2 Spacers with suitable length are available for every bicycle position.

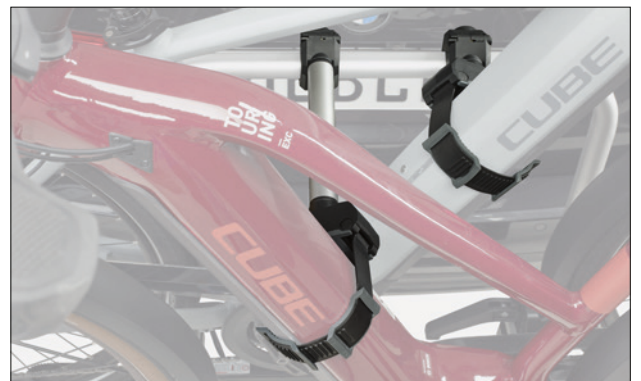

- 3 The bicycles are fixed on the rack frames by the spacers.

Uebler offers two types of spacers for fixing different bicycle variants on Uebler bike racks. The spacer with clamps is suitable for all bicycle frames with a round tube up to 75 mm \varnothing or an oval tube up to 75x45 mm \varnothing . The spacer with toothed belt is used for bicycle frames with larger dimensions. The maximum frame sizes are then up to 115 mm \varnothing for a round tube, up to 120x80 mm for a rectangular tube and up to 95x95 mm for a square tube.

i-Series / i-Series DC

Innovation & Perfection



A successful symbiosis of intelligent, lightweight construction and perfect engineering: the revolutionary and patented IQ fastener allows safe, simple and lever-free attachment. Like the entire product range, the premium carriers of the i-series consistently epitomise safety, product quality and resilience. Since their market launch in 2017, they have already won 23 tests. The carrier series was not only awarded as one of the most lightweight, but also as one of the most user-friendly in its class. The best ratings by far were also achieved for the design.

For the 2023 season, the new i31 Z and i41 S models will once again set new standards: With a very low unladen weight, a particularly high payload is possible without the need for additional securing to the vehicle.

“Made in Germany” – with a 3-year guarantee.

- Easy and labour-saving attachment to the towbar with leverless, patented IQ quick-release fastener
- Patented, removable spacers with single-hand operation
- New extra-wide wheel rails for tyre widths up to 4.5 inches
- Foldable wheel rail and lamp unit
- Ratchet system for securely attaching the wheels to the wheel rail
- Convenient release of the folding function with foot lever
- Quick-release lever for fixing the wide carrier frame
- Simultaneously locking anti-theft device
- Low unladen weight for high carrying comfort and large payloads



SMALL
FOLDING SIZE



EXTRA EASY
ASSEMBLY



ASSEMBLY
WITHOUT TOOLS



ANTI-THEFT
DEVICE



SUITABLE
FOR E-BIKES

Summary of all technical
data of the i-series - see
page 16/17.



i21

Art.-No. 15900



- For 2 bikes
- Tilt down angle 60°
- Max. load capacity 60 kg
- Self-weight 13 kg
- 2 removable bike holders

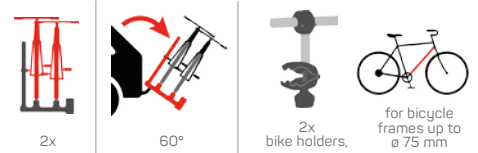

i21-DC

Art.-No. 15900-DC

- With Distance Control



- Folded

i21 Z

Art.-No. 18110

NEW



- For 2 bikes
- Tilt down angle 90°
- Max. load capacity 60 kg
- Self-weight 13,5 kg
- 2 removable bike holders with toothed belt and carbon protection

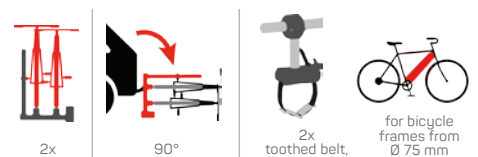

i21 Z-DC*

Art.-No. 18110-DC

- With Distance Control



- Folded

*available starting spring 2023

i-Series / i-Series DC

i31 S

Art.-No. 15910



- For 3 bikes
- Tilt down angle 60°
- Max. load capacity 54 kg
- Self-weight 16 kg
- 3 removable bike holders

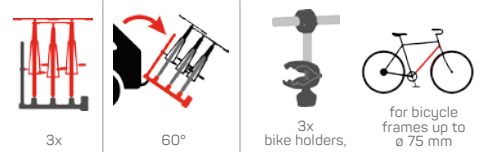

i31 S-DC

Art.-No. 15910-DC

- With Distance Control



- Folded

i31 Z

Art.-No. 18130

NEW



- For 3 bikes
- Tilt down angle 60°
- Max. load capacity 72 kg
- Self-weight 18 kg
- 3 removable bike holders with toothed belt and carbon protection

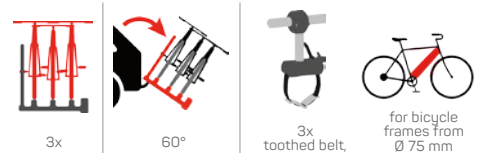

i31 Z-DC

Art.-No. 18130-DC

- With Distance Control



- Folded

i41 S

Art.-No. 18140



- For 4 bikes
- Tilt down angle 90°
- Max. load capacity 60 kg
- Self-weight 20 kg
- 4 removable bike holders

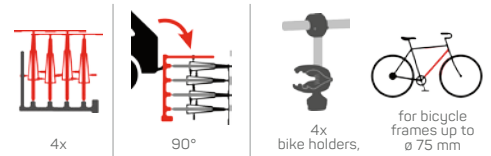

i41 S-DC

Art.-No. 18140-DC

- With Distance Control



- Folded

Distance Control (DC)



These innovative carrier systems with the integrated Distance Control (DC) parking aid at the highest Uebler standard combine all the advantages of the respective products with additional convenience when reversing and parking. Obstacles are detected unerringly and are indicated visually and acoustically.



The electronic parking aid is automatically activated when reverse gear is engaged and the distance warning system installed as standard in the vehicle is switched off. Separate wiring with the vehicle is not necessary. The reception display is simply plugged into the cigarette lighter or an on-board socket and is immediately ready for use.

X-Series

Handling & Lightness



Since its launch in 2011, the X21 series has set clear standards with 26 product test wins/best ratings, which also applies to the latest wins/best rating generation. Apart from being lightweight and stable, these racks are characterised by the easiest possible handling and their unique folding concept. Ergonomically well thought-through, functional and easy to understand, and at the same time extremely stable and resistant.

"Made in Germany" - with a 3-year guarantee.

- Lightweight and compactly folding, enables easy handling and stowing away
- Patented quick-release lock with anti-theft device
- Bike rails easily folded using integrated handle
- Extremely convenient tilt mechanism using a large foot pedal
- Safe transport of all bicycle types and e-bikes
- Low self-weight for high carrying convenience and large load capacity
- Removable bike holders with one-hand operation and anti-theft device
- Preset quick-release levers for easy and secure fastening of the U-bar
- Ratchet system for secure fixing of the bike wheels, centred on the bike rail
- "Eli" design lights series, slidable sideways
- One key for all locks



SMALL
FOLDING SIZE



EXTRA EASY
ASSEMBLY



ASSEMBLY
WITHOUT TOOLS



ANTI-THEFT
DEVICE



SUITABLE
FOR E-BIKES

Summary of all technical data of the
X-Series - see page 17.

X21 S

Art.-No. 15760



- For 2 bikes
- Tilt down angle 60°
- Max. load capacity 60 kg
- Self-weight 14 kg
- 2 removable bike holders

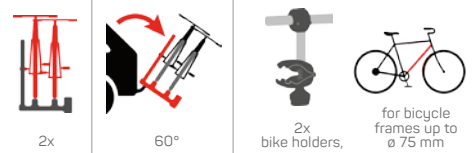

2x

60°

2x
bike holders,

for bicycle
frames up to
ø 75 mm



- Folded

X31 S

Art.-No. 15770



- For 3 bikes
- Tilt down angle 60°
- Max. load capacity 54 kg
- Self-weight 16,5 kg
- 3 removable bike holders

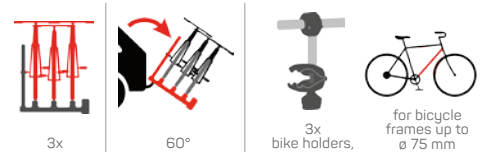

3x

60°

3x
bike holders,

for bicycle
frames up to
ø 75 mm



- Folded

F-Series

Reduction & Ergonomics

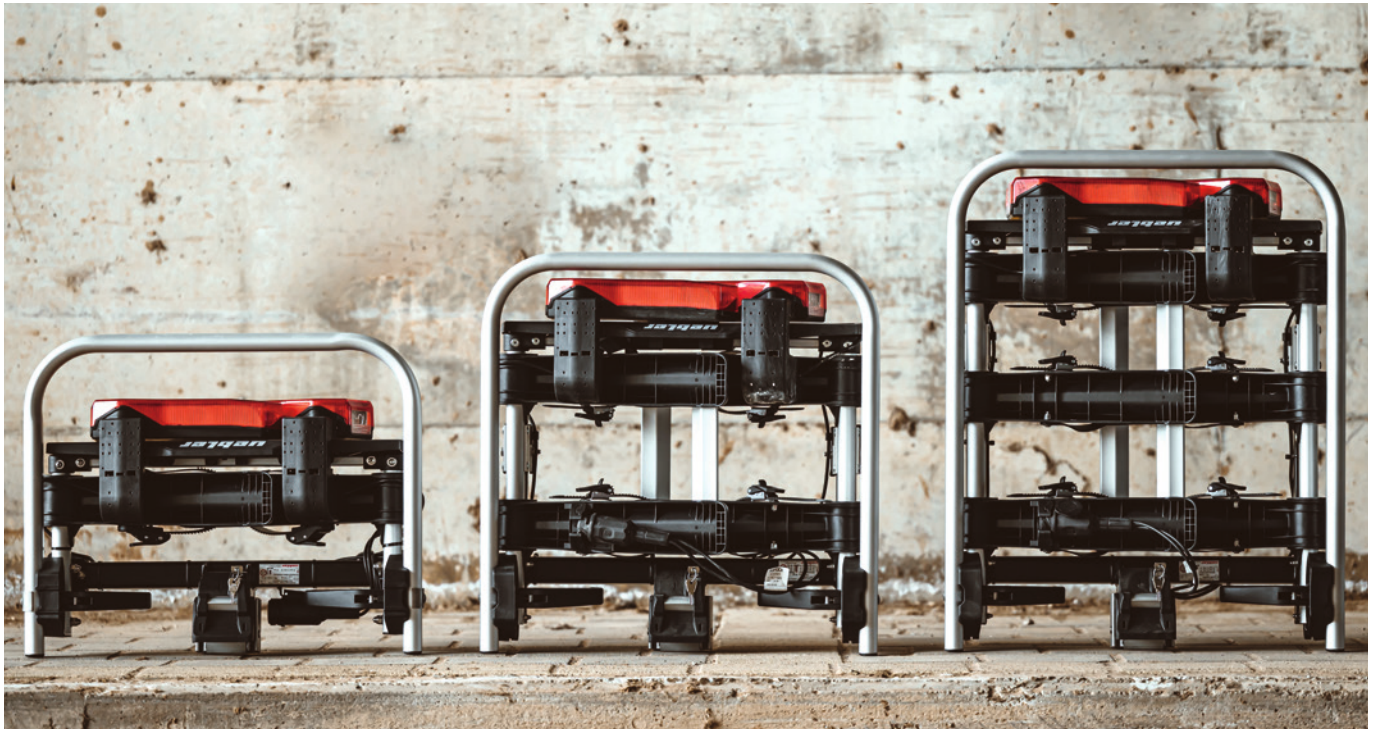

The F-series is the highlight when it comes to individualism and easiness. Easily mounted – easily loaded – easily transported – easily dismantled. Individualists are in the right place here: With the bike rack for only one bicycle, Uebler offers one of the lightest and, when folded together, one of the most compact tow-bar bike racks on the market. The F-Series naturally also includes variants for transporting 2 or 3 bicycles. Ergonomic down to the smallest detail and mounted in seconds. The patented quick-release lock ensures safe and convenient transport. All racks are completely fold-away, however, they cannot be tilted down on the vehicle.

“Made in Germany” - with a 3-year guarantee.

- Lightweight and compactly folding, enables easy handling and stowing away
- Patented IQ fastener with anti-theft device
- Low self-weight for high carrying convenience
- Safe transport of all bike types and e-bikes
- Partly removable bike holders with one-hand operation and anti-theft device
- Removable spacers with one-hand operation and anti-theft device
- Ratchet system for secure fixing of the bike wheels, centred on the bike rail
- “Isi” design light series
- One key for all locks



SMALL FOLDING SIZE



EXTRA EASY ASSEMBLY



ASSEMBLY WITHOUT TOOLS



ANTI-THEFT DEVICE



SUITABLE FOR E-BIKES

Summary of all technical data of the F-Series - see page 16.

F14

Art.-No. 15940



● Folded

- For 1 bike
- Max. load capacity 30 kg
- Self-weight 9,9 kg
- 1 removable bike holder

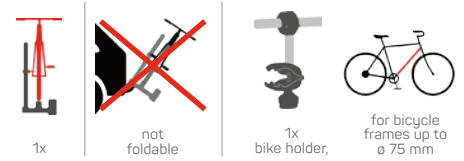

F24

Art.-No. 15950



● Folded

- For 2 bikes
- Max. load capacity 60 kg
- Self-weight 12 kg
- 2 removable bike holders

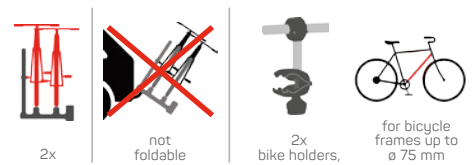

F34

Art.-No. 15960



● Folded

- For 3 bikes
- Max. load capacity 54 kg
- Self-weight 14,5 kg
- 3 removable bike holders

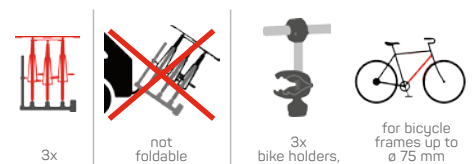

P-Series

Flexibility through Extension



The P-series racks can be extended by one rail each if necessary and so can be flexibly adapted to your needs. And it goes without saying that they are also equipped with a patented quick-release lock and the well thought-through ergonomic principle of all Ueblerr bike racks.

These racks have convincing features such as innovative, removable bike holders for bikes, optimised quick-release fasteners and the modern, slidable light system.

"Made in Germany" - with a 3-year guarantee.

- Stable, safe and practical
- Patented quick-release lock with anti-theft device

- Extremely convenient tilt mechanism using a large foot pedal
- Safe transport of all bike types and e-bikes
- Low self-weight for high carrying convenience and large load capacity
- Removable bike holders with one-hand operation and anti-theft device
- Preset quick-release levers for easy and secure fastening of the U-bar
- Ratchet system for optimum fixing of the bike wheels, centred on the bike rail
- "Eli" design lights series, slidable sideways
- One key for all locks



EXTRA EASY
ASSEMBLY



ASSEMBLY
WITHOUT TOOLS



ANTI-THEFT
DEVICE



SUITABLE
FOR E-BIKES

Summary of all technical data
of the P-Series - see page 17.

P22 S
Art.-No. 15800



● Folded

- For 2 bikes
- Tilt down angle 90°
- Max. load capacity 60 kg
- Self-weight 14 kg
- 2 removable bike holders
- Extendable for 3rd bike

Extension kit for 3rd bike

- Bike rails with ratchet system
- Bike holder for 3rd bike
- Complete max. load capacity 52 kg

Art.-No. 19710

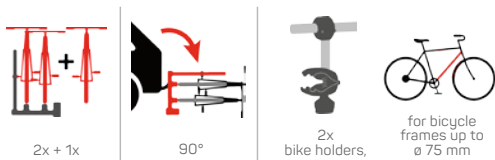

P32 S
Art.-No. 15810



● Folded

- For 3 bikes
- Tilt down angle 60°
- Max. load capacity 54 kg
- Self-weight 16 kg
- 3 removable bike holders
- Extendable for 4th bike

Extension kit for 4th bike

- Bike rails with ratchet system
- Bike holder for 4th bike
- Complete max. load capacity 72 kg
- 2 tension belts

Art.-No. 19720

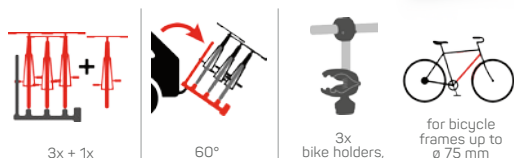

Check with the respective car manufacturer whether rack with securing straps can be used!

Simple mounting of the towbar bike racks

Uebler towbar bike racks are available, depending on the model, with two different patented quick-release lock systems. The traditional quick-release lever lock or the modern IQ fastener. Both variants enable easy and uncomplicated fixing of the towbar bike rack on the towbar coupling. Above all, the IQ fastener enables all customers to fix the towbar bike rack on the vehicle conveniently, without exerting any force. Try it out for yourself at your local trading partner, you will be impressed!

Both quick-release locks systems are suitable for all standard car towbar systems.

IMPORTANT: Always note the support load of the towbar!

Quick-release lever lock:

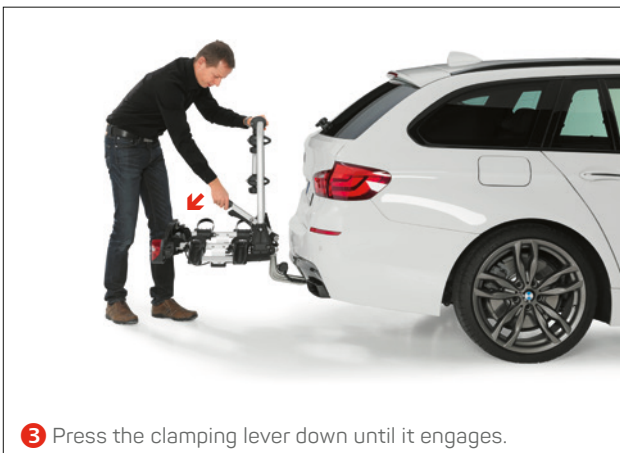
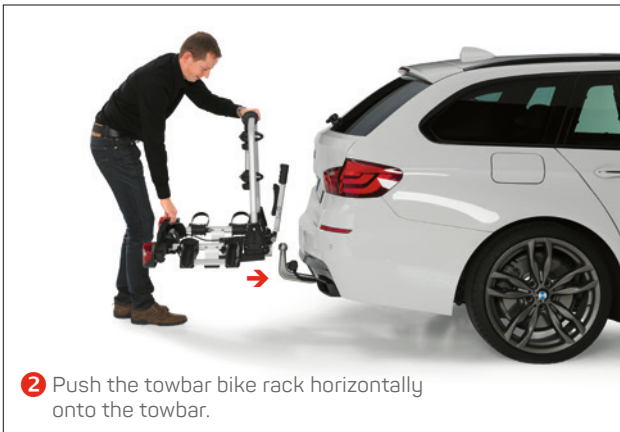
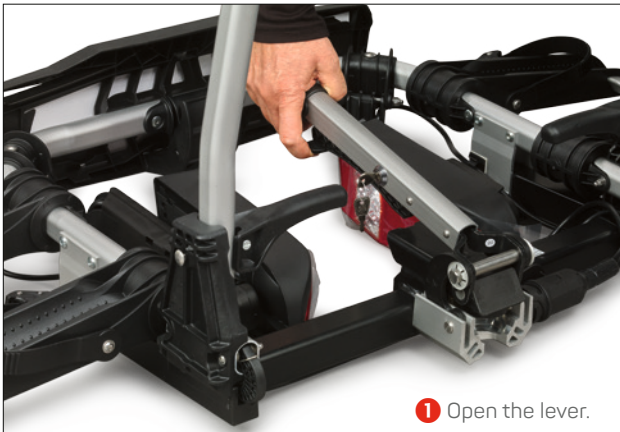

IQ fastener:

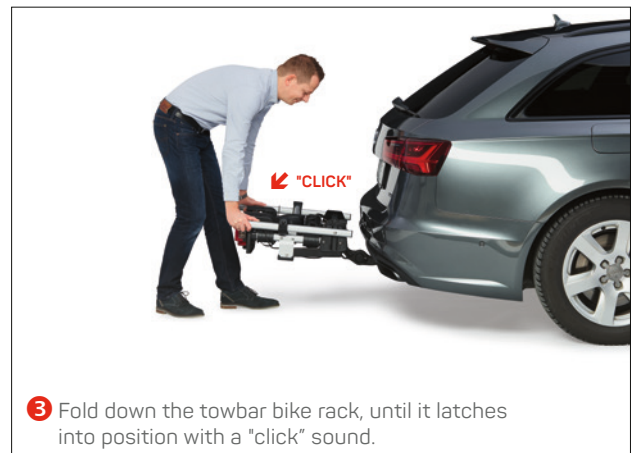
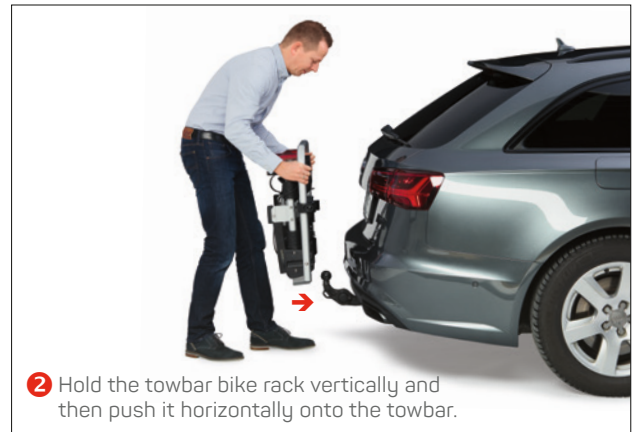

Primavelo

Ueblor tailgate racks Primavelo T6 Basis

Art.-No. 30360



- For 2 bikes
- Integrated anti-theft device
- Max. load capacity 60 kg (30 kg per bike rail)
- Self-weight only 11,5 kg
- Removable, lockable bike holders
- Extendable for 3rd bike

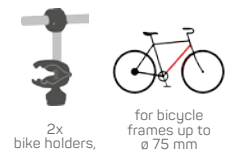
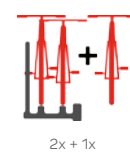

**Extension kit
for 3rd bike
Art.-No. 19561**



Ueblor tailgate racks Primavelo T6 Family

Art.-No. 30364



- For 4 bikes
- Integrated anti-theft device
- Max. load capacity 70 kg (1st/2nd bike rail max. 30 kg each, 3rd/4th bike rail max. 17.5 kg each)
- Self-weight only 16 kg
- Removable, lockable bike holders

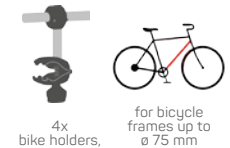
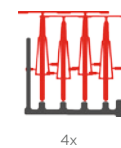

Important: The primavelo tailgate bike racks are only suitable and approved for the following vehicles:

| Vehicle type | year built | Art.-No. | Art.-No. Extension for 3rd bike | Anti-theftdevice |
|--|------------|----------|---------------------------------|------------------|
| Volkswagen | | | | |
| Bus T6 with tailgate for 2 bikes | from 07/15 | 30360 | 19561 | standard |
| Bus T6 with tailgate, complete for 4 bikes | from 07/15 | 30364 | — | standard |

Overview towbar bike racks

i-Series / DC-Series

| Technical details | i21 / i21-DC | i21 90° Z / i21 90° Z-DC | i31 / i31-DC |
|---|---|--|---|
| Product number | 15900 / 15900-DC | 18110 / 18110-DC | 15910 / 15910-DC |
| Number of bikes | 2 | 2 | 3 |
| Suitable for e-bikes | ✓ | ✓ | ✓ |
| Dimensions (W x H x D) | 118 x 69 x 56 cm | 119 x 72 x 64 cm | 118 x 84 x 71 cm |
| Dimensions (W x H x D), folded up | 61 x 20 x 60 cm | 61 x 20,5 x 69 cm | 61 x 21 x 76 cm |
| Weight | 13 kg | 13,5 kg | 16 kg |
| Maximum load capacity (Important: Please note the D-value of your towbar!) | 37 kg from SL 50 kg 60 kg from SL 75 kg | 36,5 kg from SL 50 kg 60 kg from SL 73,5 kg | 34 kg from SL 50 kg 54 kg from SL 75 kg |
| Maximum wheelbase of the bike | 130 cm | 130 cm | 130 cm |
| Can be tilted down, even with bikes | 60 degrees | 90 degrees | 60 degrees |
| Bike frame diameter | up to 75 mm round tube or 75 x 45 mm oval tube | up to 115 mm Ø for a round tube, 120x80 mm for a rec- tangular tube, 95x95 mm for a square tube | up to 75 mm round tube or 75 x 45 mm oval tube |
| Bike anti-theft device / lockable | ✓ | ✓ | ✓ |
| Rack anti-theft device / lockable | ✓ | ✓ | ✓ |
| Track spacing | 220 mm | 240 mm | 190 / 180 mm |
| EuroBE / TÜV- and DEKRA-certified | ✓ | ✓ | ✓ |
| Maximum allowable bike tyre width | 2,8" (approx. 7 cm) 4,5" (approx. 11,5cm) | 3" (approx. 7 cm) [4,5" (approx. 11,5 cm)]* | 2,8" (approx. 7 cm) 4,5" (approx. 11,5cm) |
| Quality product, made in Germany | ✓ | ✓ | ✓ |
| Special equipment | Lever-free mounting Removable bike holders | Lever-free mounting Removable bike holders with toothed belt | Lever-free mounting Removable bike holders |

F-Series

| Technical details | F14 | F24 | F34 |
|---|---|---|---|
| Product number | 15940 | 15950 | 15960 |
| Number of bikes | 1 | 2 | 3 |
| Suitable for e-bikes | ✓ | ✓ | ✓ |
| Dimensions (W x H x D) | 118 x 57 x 38 cm | 118 x 67 x 56 cm | 118 x 82 x 71 cm |
| Dimensions (W x H x D), folded up | 61 x 20 x 50 cm | 61 x 20 x 60 cm | 61 x 20 x 75 cm |
| Weight | 9,9 kg | 12 kg | 14,5 kg |
| Maximum load capacity (Important: Please note the D-value of your towbar!) | 30 kg from SL 50 kg 30 kg from SL 75 kg | 38 kg from SL 50 kg 60 kg from SL 75 kg | 35,5 kg from SL 50 kg 54 kg from SL 75 kg |
| Maximum wheelbase of the bike | 130 cm | 130 cm | 130 cm |
| Can be tilted down, even with bikes | — | — | — |
| Bike frame diameter | up to 75 mm round tube or 75 x 45 mm oval tube | up to 75 mm round tube or 75 x 45 mm oval tube | up to 75 mm round tube or 75 x 45 mm oval tube |
| Bike anti-theft device / lockable | ✓ | ✓ | ✓ |
| Rack anti-theft device / lockable | ✓ | ✓ | ✓ |
| Track spacing | — | 220 mm | 190 / 180 mm |
| EuroBE / TÜV- and DEKRA-certified | ✓ | ✓ | ✓ |
| Maximum allowable bike tyre width | 2,8" (approx. 7 cm) 4,5" (approx. 11,5cm) | 2,8" (approx. 7 cm) 4,5" (approx. 11,5cm) | 2,8" (approx. 7 cm) 4,5" (approx. 11,5cm) |
| Quality product, made in Germany | ✓ | ✓ | ✓ |
| Special equipment | Lever-free mounting Removable bike holders | Lever-free mounting Removable bike holders | Lever-free mounting Removable bike holders |

[]* With toothed belt kit for fatbikes.

A 3-year guarantee applies to all products!

i-Series / DC-Series

X-Series

| i31 Z / i31 Z-DC | i41 S / i41 S-DC | X21 S | X31 S |
|---|---|---|---|
| 18130 / 18130-DC | 18140 / 18140-DC | 15760 | 15770 |
| 3 | 4 | 2 | 3 |
| ✓ | ✓ | ✓ | ✓ |
| 119 x 89 x 78 cm | 119 x 73 x 91 cm | 119 x 77 x 64 cm | 119 x 77 x 79 cm |
| 61 x 22 x 82 cm | 61 x 23 x 91 cm | 63 x 24 x 64 cm | 63 x 24 x 79 cm |
| 18 kg | 20 kg | 14 kg | 16,5 kg |
| 57 kg from SL 75 kg 72 kg from SL 90 kg | 55 kg from SL 75 kg 60 kg from SL 80 kg | 36 kg from SL 50 kg 60 kg from SL 75 kg | 33,5 kg from SL 50 kg 54 kg from SL 75 kg |
| 130 cm | 130 cm | 130 cm | 130 cm |
| 60 degrees | 90 degrees | 60 degrees | 60 degrees |
| up to 115 mm Ø for a round tube, 120x80 mm for a rectangular tube, 95x95 mm for a square tube | up to 75 mm round tube or 75 x 45 mm oval tube | up to 75 mm round tube or 75 x 45 mm oval tube | up to 75 mm round tube or 75 x 45 mm oval tube |
| ✓ | ✓ | ✓ | ✓ |
| ✓ | ✓ | ✓ | ✓ |
| 220 / 200 mm | 190 / 180 / 180 mm | 220 mm | 190 / 180 mm |
| ✓ | ✓ | ✓ | ✓ |
| 3" (approx. 7 cm) [4,5" (approx. 11,5 cm)]* | 3" (approx. 7 cm) [4,5" (approx. 11,5 cm)]* | 2.8" (approx. 7cm) [4,5" (approx. 11,5 cm)]* | 2.8" (approx. 7cm) [4,5" (approx. 11,5 cm)]* |
| ✓ | ✓ | ✓ | ✓ |
| Lever-free mounting Removable bike holders with toothed belt | Lever-free mounting Removable bike holders | Removable bike holders | Removable bike holders |

P-Series

| P22 S | P32 S |
|--|--|
| 15800 | 15810 |
| 2, extendable for 3rd (Art.-No. 19710) | 3, extendable for 4th (Art.-No. 19720) |
| ✓ | ✓ |
| 115 x 77 x 65 cm | 115 x 77 x 79 cm |
| — | — |
| 14 kg (15 kg with extension) | 16 kg (16.5 kg with extension) |
| 35 kg from SL 50 kg 60 kg from SL 75 kg | 34 kg from SL 50 kg 54 kg from SL 75 kg |
| 125 cm | 125 cm |
| yes / 90 degrees | yes / 60 degrees |
| up to 75 mm round tube or 75 x 45 mm oval tube | up to 75 mm round tube or 75 x 45 mm oval tube |
| ✓ | ✓ |
| ✓ | ✓ |
| 220 / 180 mm (2nd to 3rd bike) | 190 / 180 mm (3rd to 4th bike) |
| ✓ | ✓ |
| 2.8" (approx. 7cm) [4,5" (approx. 11,5 cm)]* | 2.8" (approx. 7cm) [4,5" (approx. 11,5 cm)]* |
| ✓ | ✓ |
| Removable bike holders Optionally extendable for 3rd bike | Removable bike holders Optionally extendable for 4th bike |

Subject to change due to technical development.

Accessories



● Transport bag /i-Series

für Uebler Kupplungsträger

i21 **Item No. 19840**

i21-Z **Item No. 25020**

i31 **Item No. 19850**

i31-Z **Item No. 25030**



● Transport bag /i-Series

für Uebler Kupplungsträger

i41-S **Item No. 25040**



● Transport bag /X-Series

für Uebler Kupplungsträger

X21 S **Item No. 19670**

X31 S **Item No. 19680**



● Transport bag /F-Series

für Uebler Kupplungsträger

F14 **Item No. 25060**

F24 **Item No. 19840**

F34 **Item No. 19850**



● Extension kit for 3rd bike

für Uebler towbar bike rack P22 S

Item No. 19710



● Extension kit for 4th bike

für Uebler towbar bike rack P32 S

Item No. 19720



● Extension kit for 3rd bike

für Primavelo T6 Basis

Item No. 19561



● Loading ramp

für Uebler towbar bike rack of series X and P; foldable; including bag

Item No. 19940



● Drive-on and drive-over ramp (foldable)

für Uebler towbar bike rack of series i and F; foldable; including bag

Item No. 19950



● Bike holder for 1st bike

removable; lockable; for bike frames up to 75 mm round tube or 75 x 45 mm oval tube

Item No. 19880



● Bike holder for 1st bike, longer version

removable; lockable; for bike frames up to 75 mm round tube or 75 x 45 mm oval tube

Item No. 19930



● Bike holder for 2nd bike (for 2-bike rack)

removable; lockable; for bike frames up to 75 mm round tube or 75 x 45 mm oval tube

Item No. 19890



● **Bike holder for 2nd bike**
(for 3-bike rack)

removable; lockable;
for bike frames up to 75 mm
round tube or 75 x 45 mm oval tube

Item No. 19900



● **Padding**
(carbon protection)

for toothed belts;
(1 set = 4 pieces)

Item No. 25050



● **Bike holder 3rd/4th bike**
(from bike to bike)

lockable; for bike frames up to
75 mm round tube or 75 x 45 mm
oval tube

Item No. 19910



● **Toothed belt conversion**
kit for fatbikes

Length 46 cm; up to 4.5" tyre
width; (1 set = 4 pieces)

for the series X and P
Item No. 19870

for the series i and F
Item No. 25010



● **Bike holder with toothed**
belt for 1st bike

removable; lockable; with carbon
protection; for all bike frames
(including boxsection frames)
up to 120x80 mm

Item No. 19960



● **Ratchet set**
conversion kit

for all aluminium bicycle rails;
(1 set = 4 pieces)

Item No. 19470



● **Bike holder with toothed**
belt for 2nd bike
(for 2-bike rack)

removable; lockable; with carbon
protection; for all bike frames
(including box-section frames)
up to 120x80 mm

Item No. 19970



● **Tension belts**

universals; length 60 cm;
(1 set = 2 pieces)

Item No. 1606



● **Bike holder with toothed**
belt for 2nd bike
(for 3-bike rack)

removable; lockable; with carbon
protection; for all bike frames
(including box-section frames)
up to 120x80 mm

Item No. 19980



● **Drawbar adapter**

universal drawbar adapter
for caravans

Item No. 19460



● **Bike holder with toothed**
belt for 3rd/4th Bike
(from bike to bike)

lockable; with carbon protection;
for all bike frames (including box-
section frames) up to 120x80 mm

Item No. 19990

uebler

B I K E R A C K S



www.uebler.com

Uebler GmbH

Daimlerstraße 22
91301 Forchheim
Germany

Telefon: +49 (0) 9191 7362-0

info@uebler.com
www.uebler.com

Subject to change due to technical development.

Issued by:

Authorised Uebler dealer